

CGT



## FM-A

### Flush Mount Ceiling Light

- Ultra-thin 14mm(0.55")
- CCT Switchable
- ETL cETL Listed

VERSION: V1

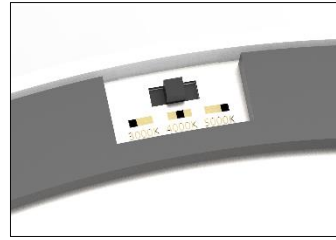

3CCT Selectable



Perfect Finish

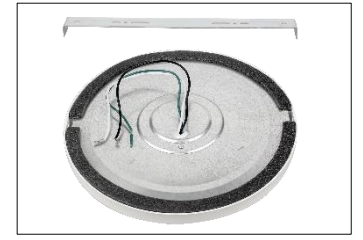

Easy Installation

### SOLID CONSTRUCTION, BUILT TO LAST

Elongated  
Wires  
Easy to Connect

Mounting  
Bracket  
for Junction Box

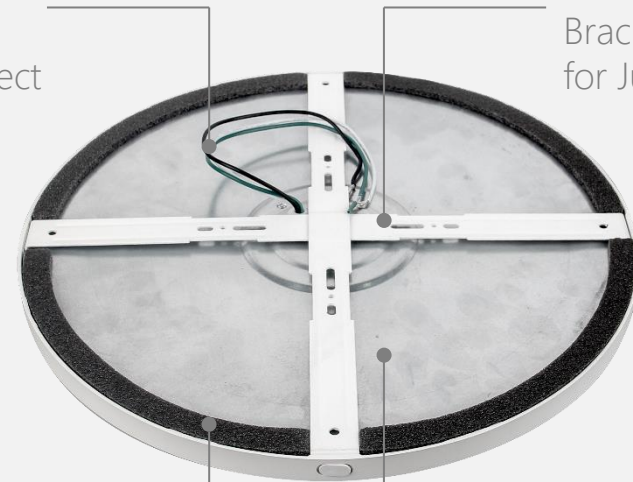

Soft Foam Layer  
Scratch-Free, Dust-  
Free

Aluminum Housing  
for Fast Heat Sink

## Parameter

Model No.	FM-12A	FM-18A	FM-24A
Dimension	Φ185* (7")	Φ225* (9")	Φ300* (12")
Height	14mm(0.55")	14mm(0.55")	14mm(0.55")
Wattage	12W	18W	24W
LED QTY	36x2	54x2	72x2
Luminous Efficacy	75lm/w	85lm/w	90lm/w
Lumens	900lm	1530lm	2160lm
CCT	CCT Switchable, 3000K, 4000K, 5000K		
CRI	80+		
Beam Angle	120°		

### Input Voltage

120Vac, 50-60hz, PF>0.9, THD <20%

### LED Chips

SMD2835, 0.2W, CRI>80Ra, SDCM<3

### Housing

PC House, White Finish in Standard  
IP20 for Indoor

### Environment

Operating Temperature: -20° C ~40° C  
Installation: Mounted  
Lifespan: 50,000 Hours

## Dimension

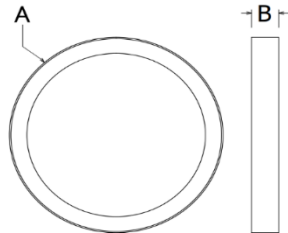

Model No.	Size A	Size B	Weight
FM-12A	Φ185* (7")	14mm(0.55")	0.36kg
FM-18A	Φ225* (9")	14mm(0.55")	0.54kg
FM-24A	Φ300* (12")	14mm(0.55")	1.18kg

## Installation

### Junction Box Mount Installation

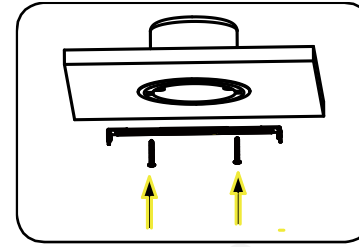

① Fixing bracket on terminal box.

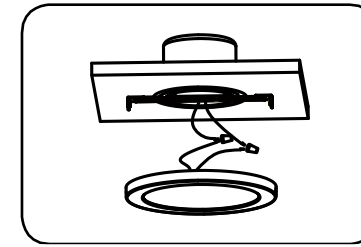

② Connecting the wire.

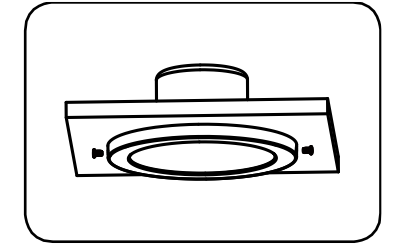

③ Fixing the lamp body on bracket and fix tightly

### Recessed Can Installation

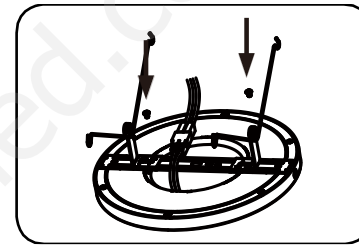

① Remove trim and existing lamp from recessed fixture.

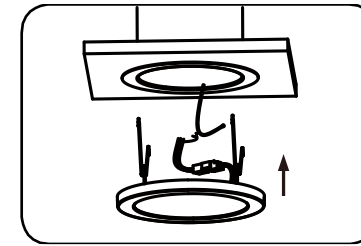

② Connecting the wire.

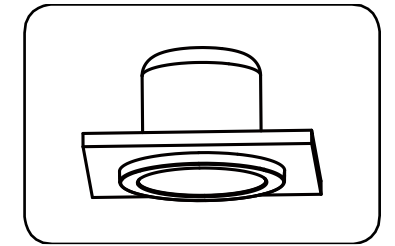

③ Press the friction blade to insert the lamp into the housing and restore power.

### EXTRA KITS

Accessories	7"	9"	12"
			X 2

## Package Information

Model No.	QTY/CTN	G.W	Carton Size	CBM	20GP	40HQ
FM-12A	60	2kg	51x31x35cm	0.056	28000pcs	69000pcs
FM-18A	10	7.2kg	27.5x27.5x32.5cm	0.025	11000pcs	27000pcs
FM-24A	10	13.8kg	35x35x34cm	0.042	6500pcs	16000pcs